

CITY OF TRAVERSE CITY



The City of Traverse City
Engineering Department
GOVERNMENTAL CENTER
400 Boardman Avenue
Traverse City, Michigan 49684

CITY OF TRAVERSE CITY
TRAFFIC COUNT MAP
TRAFFIC COUNT SHEET

Revision/Issue	Date

Date: 2005
Project No.: N.A.
Drawn by: JDM
Scale: N.A.
Sheet No.: 1 OF 1

WEST GRAND TRAVERSE BAY

EAST GRAND TRAVERSE BAY

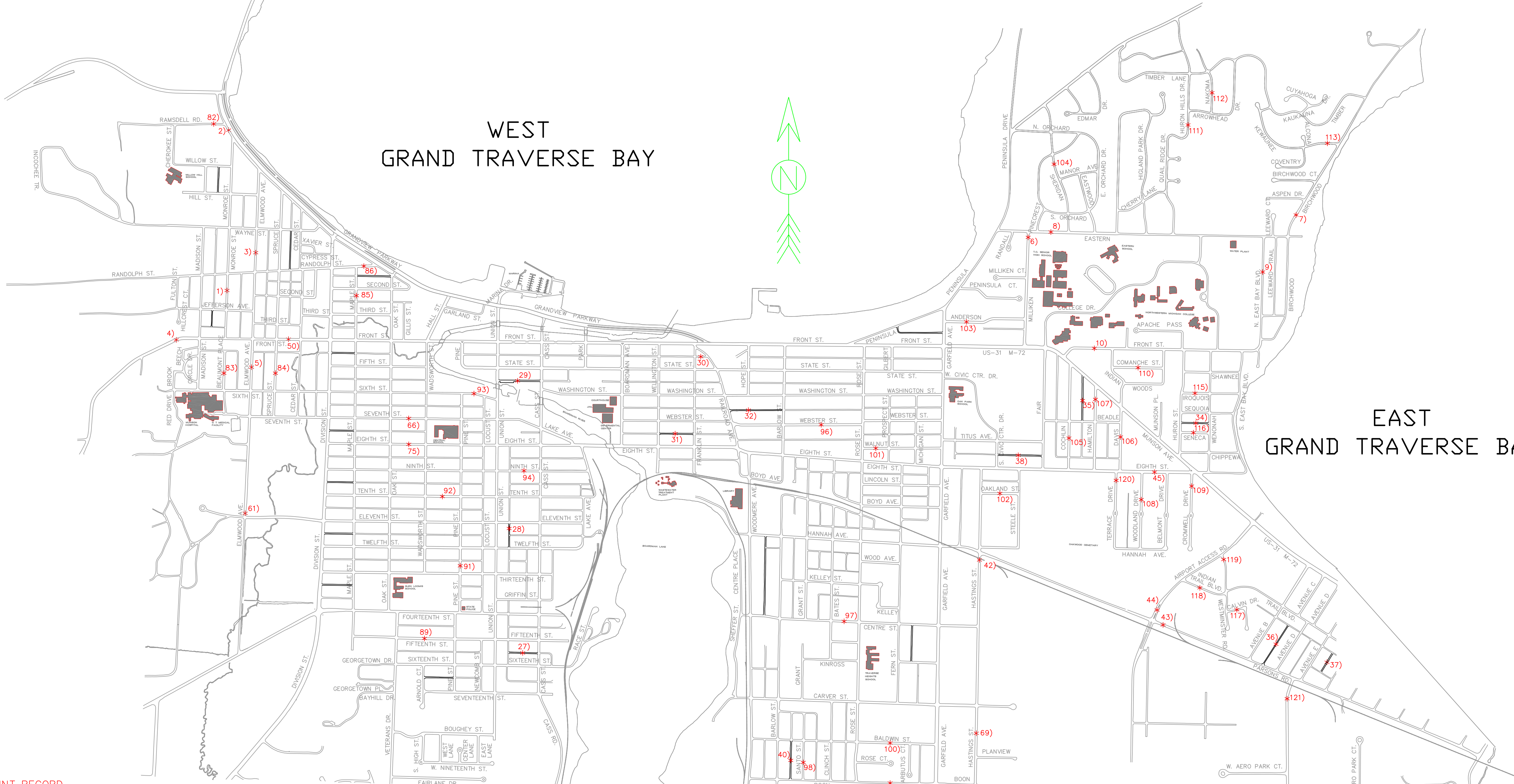

2005 TRAFFIC COUNT RECORD

#	Street	Date	Block	Car Volume
1	Monroe St.	10-20-05	200	1531
2	Bay St.	10-20-05	700	4054
3	Elmwood St.	10-20-05	400	1746
4	W. Front St.	10-20-05	1200	10825
5	Elmwood St.	10-25-05	200	2103
6	Milliken St.	10-11-05	1200	2518
7	Birchwood Ave.	10-10-05	500	1709
8	Eastern Ave.	10-11-05	1400	4924
9	East Bay Blvd.	10-10-05	200	936
10	E. Front St.	5-25-05	1500	1510
17	Alley	3-27-06	100	8
18	Alley	3-27-06	300	30
19	Alley	3-27-06	300	30
20	Alley	3-27-06	500	123
21	Alley	3-27-06	600	68
22	Alley	3-27-06	600	54
23	Alley	3-29-06	600	24
24	Alley	3-29-06	600	21
25	Alley	3-29-06	600	49
26	Alley	4-05-06	300	24
27	Alley	4-05-06	100	46
28	Alley	4-05-06	800	339
29	Alley	4-05-06	100	1263
30	Alley	4-05-06	600	101
31	Alley	4-05-06	500	270
32	Alley	4-05-06	700	102

2005 TRAFFIC COUNT RECORD

#	Street	Date	Block	Car Volume
38	Alley	4-10-06	1200	114
40	Alley	4-10-06	1200	34
42	Hastings St.	5-17-05	800	7765
43	Parsons Rd.	5-17-05	700	11401
44	Airport Access	5-17-05	800	3863
45	E. Eighth St.	5-24-05	1800	6150
50	W. Front St.	10-25-05	800	15220
66	Seventh St.	10-18-05	400	2030
69	Hastings St.	5-17-05	1100	6556
75	E. Eighth St.	10-18-05	400	2252
82	Ramsdell St.	10-20-05	1300	523
83	Beaumont Pl.	10-25-05	200	690
84	Spruce St.	10-25-05	100	522
85	Maple St.	4-24-06	200	821
86	Randolph St.	4-24-06	500	809
88	Tenth St.	3-29-06	1400	409
89	Fifteenth St.	4-24-06	500	1902
91	Pine St.	10-18-05	900	1071
92	W. Tenth St.	10-18-05	300	1459
93	Sixth St.	10-25-05	200	409
94	Ninth St.	4-24-06	100	592
96	Webster St.	4-24-06	800	652
97	Centre St.	4-24-06	800	829
98	Sante St.	4-27-06	1200	244
99	Boon St.	4-27-06	900	4033

2005 TRAFFIC COUNT RECORD

#	Street	Date	Block	Car Volume
100	Baldwin St.	4-27-06	900	1019
101	Walnut St.	4-27-06	900	717
102	Oakland St.	5-18-05	1200	81
103	Anderson Ct.	4-27-06	1200	334
104	Sheridan St.	10-10-05	600	764
105	Cochlin St.	10-11-05	400	561
106	Davis St.	10-11-05	400	589
107	Hamilton St.	10-11-05	300	193
108	Woodland Dr.	5-24-05	500	227
109	Cromwell Dr.	5-24-05	500	305
110	Comanche St.	10-11-05	1700	128
111	Huron Hills Dr.	10-10-05	700	629
112	Nakoma St.	10-10-05	700	37
113	Kewaunee Dr.	10-10-05	2200	324
115	Iroquois St.	5-25-05	1900	64
116	Senneca St.	5-24-05	1900	67
117	Colvin Dr.	5-17-05	800	126
118	Indian Trail Blvd.	5-17-05	700	434
119	Westminster Rd.	5-17-05	700	593
120	Terrace Dr.	5-18-05	500	179
121	Aero Park Dr.	5-16-05	2400	3814